

# WAH PEDAL SHELL



LEFT

Toe End

RIGHT

Heel End

# WAH PEDAL SHELL ASSEMBLY INSTRUCTIONS

## Tools and materials you will need to complete the assembly:

- Small metal file or medium to coarse grit emery cloth for clean off flash on some pedal surfaces
- A #1 or #2 point Philips screwdriver
- A 5 mm Allen wrench to tighten the tension adjustment screw
- Hammer and center punch
- Alcohol or acetone to clean the surfaces where rubber parts will be mounted
- Contact cement or other adhesive to secure the tread and pedal bumpers

## PARTS LIST

### Rack Assembly Parts:

Rack (1)



Small Screw (1)

(M3 x 0.5, L = 12 mm)

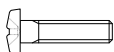

Hex Nut (1)

(M3 x 0.5)



Lock Washer (3)



Rack mount (1)

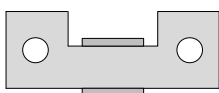

Rack Tensioner (1)



Self-Tapping Screws (3)



Center Pillow Block & Tension Adjustment Screw (1)

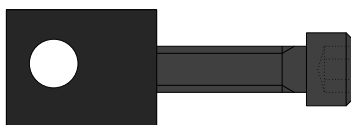

Bearing Pin (1)



Treadle (1)



Wah Base (1)

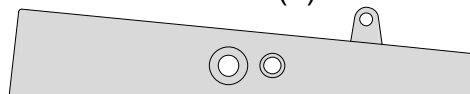

Front Bumpers (2)



Rear Bumper (1)



Felt Switch Pad (1)

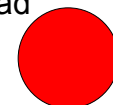

Rubber Feet, Tapered (4)



Mounting Screws (4)

(M3 x 0.5, L = 10 mm)



L-bracket (1)

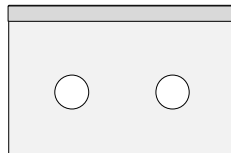

Mounting Screws (2)

(M4 x 0.70, L = 16 mm)

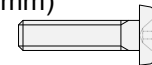

Mounting Nuts (2)

(M4 x 0.70)



Washers (2)



### Optional Parts:

Countersunk Screw with Nut (1)

(M4 x 0.70, L = 23 mm)

- Can be used to mount a circuit board

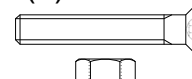

Gear for Potentiometer (1)

- If not included on your wah pot



## ASSEMBLY

### Rack Assembly and Bumpers

On the treadle, use two of the self tapping screws and lock washers to fasten the rack mount to its mounting block in the same orientation as shown in the drawing.

It may be necessary to file off some aluminum flash from the surface of the treadle mount block surface so the rack assembly will sit flush against the mounting block surface. (Because these are self tapping screws it will take considerable pressure to get the screws in).

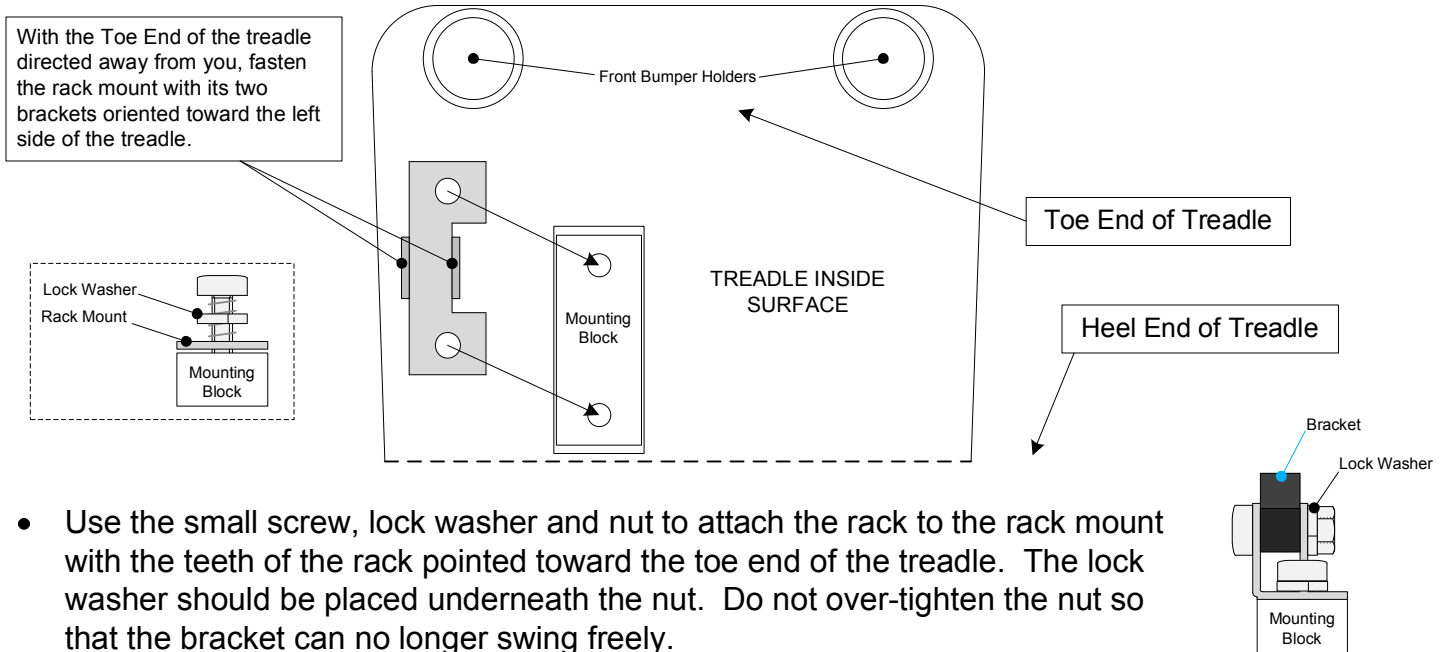

- Use the small screw, lock washer and nut to attach the rack to the rack mount with the teeth of the rack pointed toward the toe end of the treadle. The lock washer should be placed underneath the nut. Do not over-tighten the nut so that the bracket can no longer swing freely.
- Remove the paper backing on the felt pad and attach it to the treadle's inside surface centered between the two front bumper holders at the toe end. (This will cushion the footswitch when turning the pedal on and off).
- Using contact cement or other adhesive, mount the two front bumpers in the holes provided for them.
- Remove the backing from the rear bumper and mount it in the hole on top of the holder centered at the treadle's heel end.

*Treadle assembly is almost complete. We recommend that you wait until after completing the rest of the wah pedal shell assembly before attaching the rubber tread to the outer surface of the treadle. It will take some time for the glue to completely dry and it's best not to handle the treadle while the rubber tread is still drying.*

### Base Assembly

Looking at the inside surface of the base with the toe end directed away from you. Use the remaining self tapping screw to mount the rack tensioner to the hole on the bottom left side of large rectangular hole as shown in the drawing. (Keep this screw fastened loosely until after you mount your wah pot).

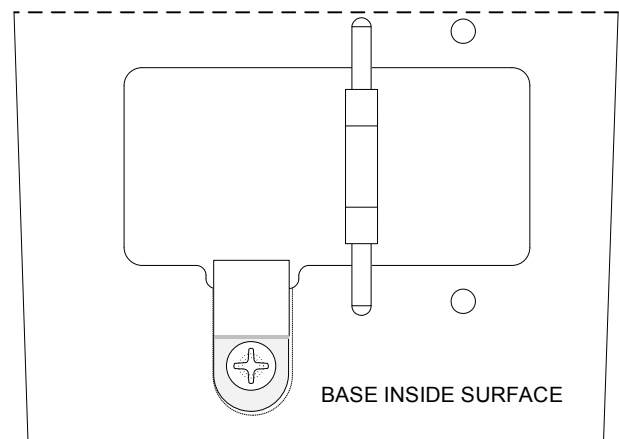

- Mount the L-bracket on the outer surface of the base using the two long 16 mm screws, nuts and flat washers as shown in the drawing. The screws should be inserted from the inside of the base so that the screw heads are on the inside of the pedal.

- Push the tension adjustment screw through the hole in the L-bracket. Place the pillow block between the two bearing pin mounts.

- Screw the tension adjustment screw part way into the threaded hole in the pillow block.

*The non-threaded hole in the pillow block is slightly off center. The side of the pillow block that the non-threaded hole is closest to should face up so that it lines up better with the two bearing pin mount holes.*

- Slide the bearing pin through the two mounts and the pillow block from left to right as shown in the drawing. Turn the tension adjustment screw with your fingers until its head is flush with the back of the L-bracket. **Do NOT tighten this screw, yet.** Slide the bearing pin out and set it aside. The pillow block is now aligned for final assembly.

### Optional Hardware

The remaining screw and nut are for optional circuit board mounting and should only be installed if your particular project requires it. Push the screw through the 3/16" hole in the middle of the base on the top surface. Put the nut on from inside the pedal and tighten. You may use your own alternate hardware for this if required for your application. It will be very difficult to install or remove a screw here once the treadle is permanently attached to the base.

The gear may be used on a splined potentiometer shaft if required for your application.

### Final Assembly

- Place the treadle on top of the base as shown in the drawing. Make sure the rack stays inserted through the large rectangular hole in the base. Line up the bearing pin holes on the treadle with those on the base. Insert the smooth end of the bearing pin from the left side of the pedal and carefully slide it through all of the bearing pin holes including: both treadle holes, both base mount holes and the pillow block hole.

*The splined end of the bearing pin should be resting against the left side hole. The hole on the left side is slightly larger than the one on the right side and attempting to press the pin in from the right side could damage your pedal assembly.*

- Using a hammer and center punch, carefully tap the splined end of the bearing pin into the hole until it is flush with the left side of the treadle.
- Adjust the tension of the adjustment screw with an Allen wrench so that the treadle stays in place when you remove your foot and so that it suits your playing preference.

